

Gear Puller & Set

- Material - chrome vanadium alloy steel
- Finishing - chrome plated & phosphate sunk

7962

- Two-Jaw gear puller

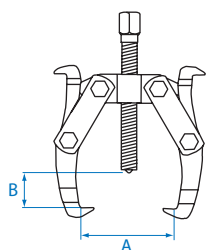

KT NO.	Capacity (tons)	HEX (mm)	Jaw (leg)	Spread (A)mm	Reach (B)mm	kg	Box / Carton
7962-03	2	14	2	75	60	0.44	1 / 40
7962-04	4	17	2	100	95	0.78	1 / 20
7962-06	6	19	2	150	160	1.65	1 / 10
7962-08	10	23	2	200	235	3.50	1 / 5
7962-12	15	32	2	300	330	7.00	1 / 2

7963

- Three-Jaw gear puller

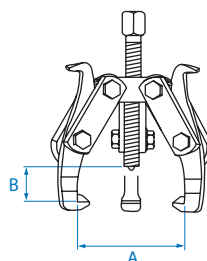

KT NO.	Capacity (tons)	HEX (mm)	Jaw (leg)	Spread (A)mm	Reach (B)mm	kg	Box / Carton
7963-03	3	14	3	75	60	0.55	1 / 40
7963-04	6	17	3	100	95	1.06	1 / 20
7963-06	9	19	3	150	160	2.25	1 / 10
7963-08	15	23	3	200	235	4.50	1 / 5
7963-12	22	32	3	300	330	11.00	1 / 2

7962B

- Two-Jaw gear puller
- Adjustable sliding arm for efficiency and safety
- Reversible jaws for internal & external options gear, axle, bearing, etc...

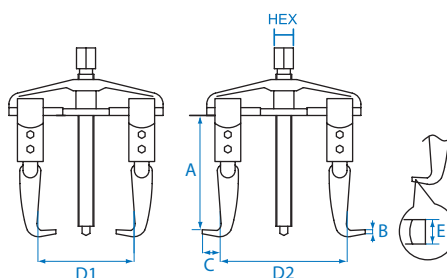
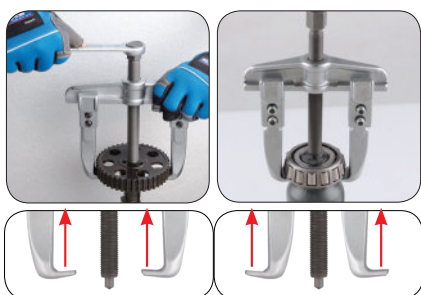

KT NO.	Capacity (tons)	Hex (mm)	Jaw (leg)	Reach A(mm)	B (mm)	C (mm)	Spread D1 (mm)	Spread D2(mm)	E (mm)	kg	Box / Carton
7962B-35	2.0	17	2	100	3.8	14.5	90	60~125	21	1.05	1/12
7962B-05	3.0	17	2	100	3.8	14.5	130	60~160	21	1.15	1/12
7962B-06	3.0	22	2	150	4.6	23.0	150	85~200	30	2.98	1/6
7962B-08	5.0	22	2	150	4.6	23.0	190	105~230	30	3.41	1/6
7962B-10	5.0	27	2	210	7.0	30.0	240	130~300	35	7.11	1/3

7962B1PR

new

- Two-Jaw gear puller
- Adjustable sliding arm for efficiency and safety
- Reversible jaws for internal & external options gear, axle, bearing, etc...

Contents

kg 18.20 1



7962B 3.5", 5", 6", 8", 10"

87155

5 PC.

